

**BEST: TO TEST!**

## **MAGNON® LED LUMINAIRES 2018**

High quality at an affordable price, robust and weather-proof

## AREAS OF APPLICATION

	PL-1000-01	PL-2000-01	PL-3000-01	PL-4000-01	SL-1000-01	NEW SL-1100-01	NEW SL-2000-01	RL-1000-01	NEW AL-1000-01
<b>Applications</b>									
Architectural lighting				■	■	■	■	■	
Stops	■	■			■	■	■	■	■
Façade illumination	■	■		■	■	■			
Storage, cellar and technical side rooms	■	■		■					
Agriculture and animal husbandry			■		■	■			
Multi-storey/aboveground/underground car parks	■	■		■	■	■		■	■
Production	■	■		■	■	■	■		
Underpass								■	■
Car wash								■	
<b>Special features</b>									
IP 65	■	■	■	■	■	■	■	■	■
Suitable for intensive cleaning processes with high-pressure cleaners – IP 69 K								■	
2 x 90° swivelling	■	■	■					■	
120° swivelling					■				
90° swivelling						■			
Ammonia-resistant			■						
Adjustable luminous flux		■							
Increased impact resistance IK 09				■				■	■

# INDEX OF PAGES

---

## INTRODUCTION

AREAS OF APPLICATION	2
INDEX OF PAGES	3



## LUMINAIRES FOR CEILING AND WALL SURFACE MOUNTING

4



PL-1000-01 8



PL-2000-01 10



PL-3000-01 12



PL-4000-01 14



## FLOODLIGHTS

18



SL-1000-01 20



SL-1100-01 22



SL-2000-01 24



## TUBULAR LUMINAIRES

26

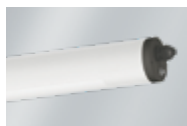

RL-1000-01 30



## VANDALISM-PROOF LUMINAIRES

32



AL-1000-01 36



## TECHNICAL INFORMATION

38

LEGAL NOTE	38
REPRESENTATIONS/WORLDWIDE	39



## LUMINAIRES FOR CEILING AND WALL SURFACE MOUNTING

The MAGNON® PL series comprises various linear LED luminaires. It includes reflector tube luminaires with a particularly widely swivelling reflector – up to 2 x 90° – and the especially flat linear luminaire PL-4000-01. This allows for applications in workshops, as forecourt lighting above

gates and doors or between wooden constructions, for example, carports. For industrial applications with high requirements when it comes to the flexibility of luminous flux, the reflector tube luminaire with adjustable luminous fluxes can be used.

Especially in the case of large-scale construction projects, the adjustable luminous flux enables high flexibility on the part of installers. An ammonia-resistant reflector tube version is especially robust and long lasting when used in stables.

**BEST: TO TEST!**









**Feuerwehr**

Einfahrt freihalten

# LUMINAIRES FOR CEILING AND WALL SURFACE MOUNTING

INDEX



PL-1000-01 8



PL-2000-01 10



PL-3000-01 12





PL-4000-01 14

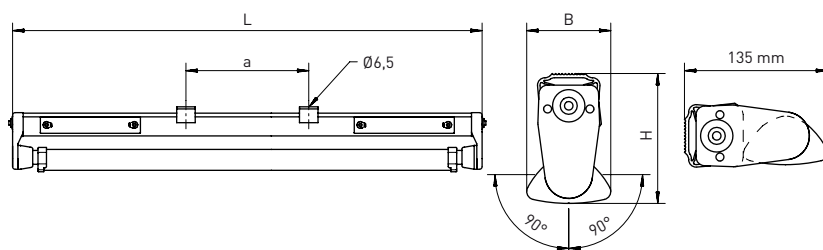

# PL-1000-01

LED



 medium beam

Lamp	Version	L	B	H	a	Max. weight
LED	m1200	1255 mm	80 mm	123 mm	600 ± 40 mm	2.8 kg
LED	m1500	1555 mm	80 mm	123 mm	900 ± 40 mm	3.4 kg

## AREAS OF APPLICATION

Polymer luminaire with LED lamps. For use in industrial and public applications and areas with special safety requirements.

## HOUSING

Weather proof and UV-resistant luminaire housing made from fibreglass-reinforced polymer, similar to RAL 9010. Unrestricted use for indoor and outdoor areas according to protection rating IP 65. Thermally separated lamp chamber and transformer chamber. Short sealing system consisting of non-ageing, form retaining silicone/synthetic rubber.

## LIGHTING TECHNOLOGY

2 x 90° swivel reflector tube made from PMMA Transopal® (impact strengthened) with internal aluminium reflector (MIRO-SILVER®).

## ELECTRICAL CONSTRUCTION

Luminaire ready for mounting and installation. Built-in transformer, 230 V AC/DC. Two side access covers, two cable entries on face side (M20) and 3 x 1.5 mm<sup>2</sup> through wiring.

## MOUNTING

Individual or row mounting. Ceiling or wall fixation using two polymer mounting clamps with variable mounting distance.

Permanent ambient temperature -25°C to +35°C. **L80 B10 > 50,000 h.**



## PL-1000-01, PMMA TRANSOPAL® (IMPACT STRENGTHENED), MEDIUM BEAM

Version	Colour temperature/K	Luminous flux*/lm	System power**/W	MAGNON® article no.
m1200	□ 840/4000	4660	41	345 480 44 21
m1500	□ 840/4000	5800	51	345 680 34 21

\* Lamp luminous flux  
 \*\* Rounded performance ratings

### PL-1000-01 CONE DIAGRAMS

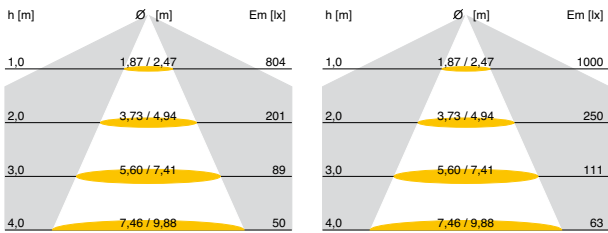

PL-1000-01, m1200, 4660 lm  
 PMMA Transopal® (impact strengthened)  
 medium beam  
 Article no. 345 480 44 21

PL-1000-01, m1500, 5800 lm  
 PMMA Transopal® (impact strengthened)  
 medium beam  
 Article no. 345 680 34 21

### SAMPLE APPLICATIONS OF SWIVEL RANGE

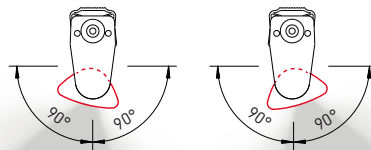

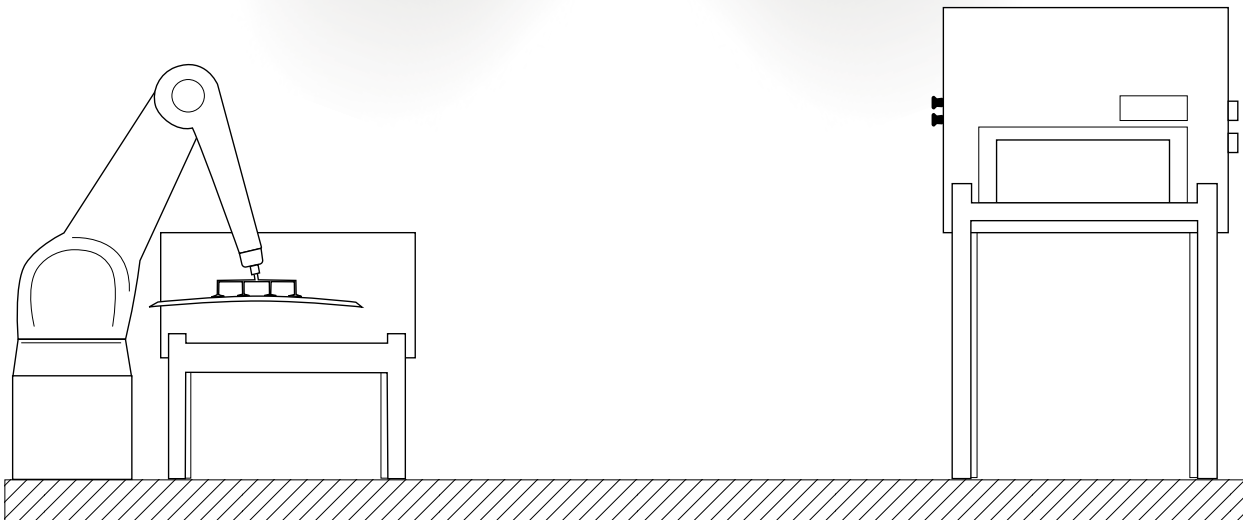

extreme  
 swivel  
 angle

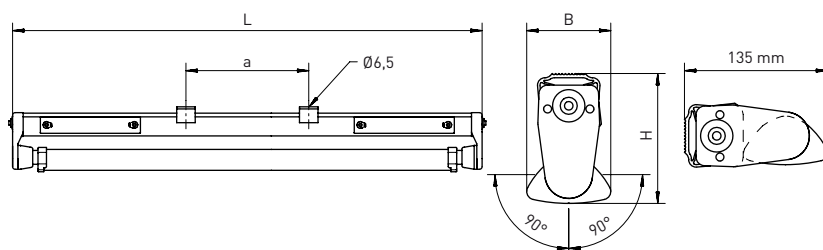

# PL-2000-01

LED



 medium beam

Lamp	Version	L	B	H	a	Max. weight
LED	m1200	1255 mm	80 mm	123 mm	600 ± 40 mm	2.8 kg
LED	m1500	1555 mm	80 mm	123 mm	900 ± 40 mm	3.4 kg

## AREAS OF APPLICATION

Polymer luminaire with LED lamps, variable adjustment of luminous flux in three stages. For use in industrial and public applications and areas with special safety requirements.

## HOUSING

Weather proof and UV-resistant luminaire housing made from fibreglass-reinforced polymer, similar to RAL 9010. Unrestricted use for indoor and outdoor areas according to protection rating IP 65. Thermally separated lamp chamber and transformer chamber. Short sealing system consisting of non-ageing, form retaining silicone/synthetic rubber.

## LIGHTING TECHNOLOGY

Reflector tube that can be swivelled 2 x 90°, made from PMMA Transopal® (impact strengthened) with internal aluminium reflector (MIRO-SILVER®).

## ELECTRICAL CONSTRUCTION

Luminaire ready for mounting and installation. Built-in transformer, 230 V AC/DC. Two side access covers, one of which has an integrated DIP switch; two face side cable entries M20 and 3 x 1.5 mm<sup>2</sup> through wiring.

## MOUNTING

Individual or row mounting. Ceiling or wall fixation using two polymer mounting clamps with variable mounting distance.

Permanent ambient temperature -25°C to +35°C. **L80 B10 > 50,000 h.**

## PL-2000-01, PMMA TRANSOPAL® (IMPACT STRENGTHENED), MEDIUM BEAM

Version	Colour temperature/K	Luminous flux*/lm	System power**/W	MAGNON® article no.
m1200	□ 840/4000	3100 - 4660	29 - 41	347 480 34 21
m1500	□ 840/4000	3900 - 5800	35 - 51	347 680 34 21

\* Lamp luminous flux  
\*\* Rounded performance ratings

adjustable  
luminous  
flux

### PL-2000-01 LUMINOUS FLUX TABLE

Version	Adjustable System power**/W	Luminous flux/lm	Version	Adjustable System power**/W	Luminous flux/lm
m1200	29	3100	m1500	35	3900
	35	3900		43	4900
	41	4660		51	5800

\*\* Rounded performance ratings  
Standard luminous flux, corresponds to the luminous flux of a luminaire with T8 of the same length

- > Housing with easy-open access covers. High level of tightness, protected against water jets according to IP 65.

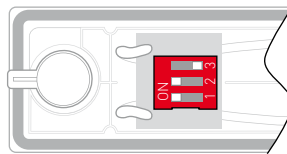

#### > NOTE:

The luminous fluxes of individual versions can be adjusted separately by means of a DIP switch integrated in the access cover for easy access. The luminaires are preset at the factory with a luminous flux similar to T8 lamps.



- > Swivelling reflector tube 2 x 90°

### PL-2000-01 CONE DIAGRAMS

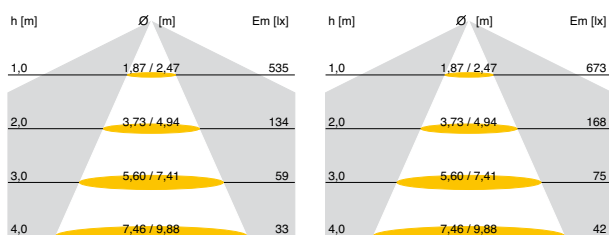

PL-2000-01, m1200, 4660 lm  
PMMA Transopal® (impact strengthened)  
medium beam  
Article no. 347 480 34 21

PL-2000-01, m1500, 5800 lm  
PMMA Transopal® (impact strengthened)  
medium beam  
Article no. 347 680 34 21





# PL-3000-01

LED

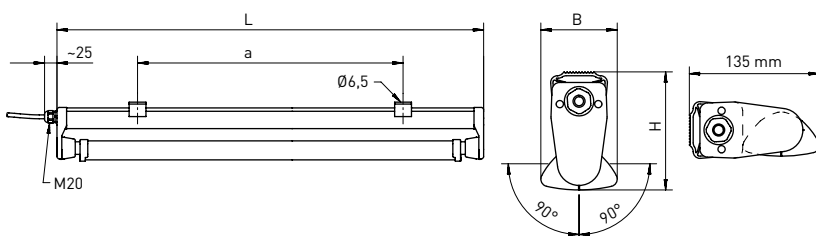

ammonia-resistant



 medium beam

Lamp	Version	L	B	H	a	Max. weight
LED	m1200	1255 mm	80 mm	123 mm	920 ± 80 mm	2.8 kg
LED	m1500	1555 mm	80 mm	123 mm	1220 ± 80 mm	3.4 kg

## AREAS OF APPLICATION

Ammonia-resistant polymer luminaire with LED lamps. Can be used in stables or aviaries with high ammonia levels and special safety requirements.

## HOUSING

Weather proof and UV-resistant luminaire housing made from fibreglass-reinforced polymer, similar to RAL 9010. Unrestricted use for indoor and outdoor areas according to protection rating IP 65.

Thermally separated lamp chamber and transformer chamber. Short sealing system consisting of non-ageing, form retaining silicone/synthetic rubber.

## LIGHTING TECHNOLOGY

Reflector tube that can be swivelled 2 x 90°, made from PMMA Transopat® (impact strengthened) with internal aluminium reflector (MIRO-SILVER®).

## ELECTRICAL CONSTRUCTION

Luminaire ready for mounting and installation. Built-in transformer, 230 V AC/DC. One M20 face side cable gland. Ready for connection using ammonia-resistant connecting cable (2 m) 2 x 2.5 mm<sup>2</sup>.

## MOUNTING

Single mounting. Ceiling or wall fixation using two polymer mounting clamps with variable mounting distance. Permanent ambient temperature -25°C to +35°C. **L80 B10 > 50,000 h.**

## PL-3000-01, PMMA TRANSOPAL® (IMPACT STRENGTHENED), MEDIUM BEAM

Version	Colour temperature/K	Luminous flux*/lm	System power**/W	MAGNON® article no.
m1200	□ 840/4000	4660	41	349 480 34 21
m1500	□ 840/4000	5800	51	349 680 34 21

\* Lamp luminous flux  
 \*\* Rounded performance ratings

### PL-3000-01 CONE DIAGRAMS

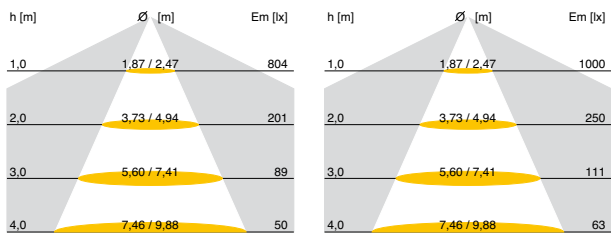

PL-3000-01, m1200, 4660 lm  
 PMMA Transopal® (impact strengthened)  
 medium beam  
 Article no. 349 480 34 21

PL-3000-01, m1500, 5800 lm  
 PMMA Transopal® (impact strengthened)  
 medium beam  
 Article no. 349 680 34 21



# PL-4000-01

LED

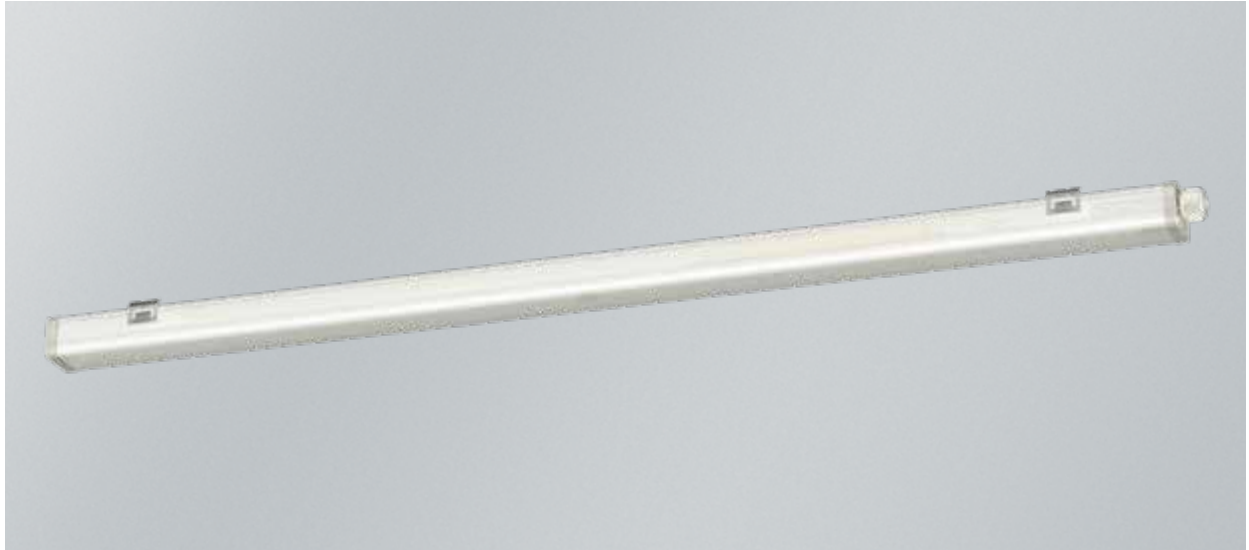

medium beam

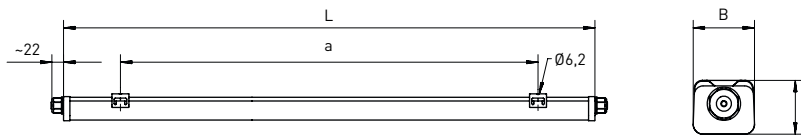

Lamp	Version	L	B	H	a	Max. weight
LED	m1200	1165 mm	58 mm	51 mm	950 mm	1.8 kg
LED	m1500	1445 mm	58 mm	51 mm	1230 mm	2.4 kg

## AREAS OF APPLICATION

Particularly slimline polymer luminaire with LED lamps. For use in industrial and public applications and areas with special safety requirements.

## HOUSING

Weather-proof and UV-resistant luminaire housing made from polymer, transparent. Unrestricted use for indoor and outdoor areas according to protection rating IP 65.

## LIGHTING TECHNOLOGY

Luminaire housing made from PC Tropal® (fracture proof) with inner aluminium reflector.

## ELECTRICAL CONSTRUCTION

Luminaire ready for mounting and installation. Built-in transformer, 230 V AC/DC. Two cable glands on face side (M20) and 3 x 1.5 mm<sup>2</sup> through wiring.

## MOUNTING

Individual or row mounting. Ceiling or wall fixation using two metal mounting clamps with variable mounting distance. Suspension system or fixation to mounting rail possible.

Permanent ambient temperature -25°C to +30°C. **L80 B10 > 50,000 h.**



## PL-4000-01, PC TROPAL® (FRACTURE PROOF), MEDIUM BEAM

Version	Colour temperature/K	Luminous flux*/lm	System power**/W	MAGNON® article no.
m1200	□ 840/4000	4660	41	411 480 34 81
m1500	□ 840/4000	5800	51	411 680 34 81

\* Lamp luminous flux  
 \*\* Rounded performance ratings



> Front view of PL-4000-01

## PL-4000-01 CONE DIAGRAMS

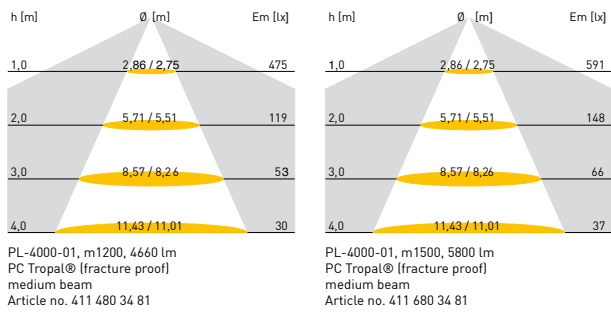





## FLOODLIGHTS

MAGNON® floodlights are made from cast aluminium or weather-proof polymer.

The SL-1000-01 and SL-1100-01 luminaires can be used outdoors without limitation and are suitable for building illumination for traffic areas or as lighting under awnings.

All floodlights (SL-1000-01, SL-1100-01 and SL-2000-01) are suitable for factory and industrial hall applications.

**BEST: TO TEST!**





# FLOODLIGHTS

INDEX



SL-1000-01 20



SL-1100-01 22



SL-2000-01 24

# SL-1000-01

LED



swivelling  
+  
energy-efficient

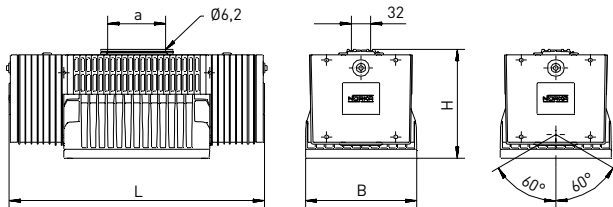

extreme wide beam

Lamp	Version	L	B	H	a	Max. weight
LED array	Floodlight	424 mm	185 mm	180 mm	96 mm	4.7 kg

## AREAS OF APPLICATION

Floodlight with LED array. For use in industrial facilities with different mounting heights, as well as the illumination of buildings, advertising spaces, car parks and other areas.

## HOUSING

Luminaire housing made from weatherproof, UV-resistant, fibreglass-reinforced polymer, black. Reflector housing made from cast aluminium, swivelling and locking up to 120°. Thermally separated lamp chamber and transformer chamber. Sealing system made from non-ageing, form retaining silicone/synthetic rubber. Protection rating IP 65, protection class II.

## LIGHTING TECHNOLOGY

LED arrays in a neutral white colour temperature. Cover screen made from single pane safety glass with internal aluminium reflector made from MIRO-SILVER®.

## ELECTRICAL CONSTRUCTION

Luminaire ready for mounting and installation. Built-in transformer, 220-240 V AC/DC supply voltage. Two face side cable entries (M20). An additional, concealed cable gland M20 at rear.

## MOUNTING

Ceiling or wall fixing using aluminium mounting clamp. Permanent ambient temperature -25°C to +40°C. **L80 B10 > 50,000 h.**

## SL-1000-01 WITH COVER SCREEN MADE FROM SINGLE PANE SAFETY GLASS, EXTREME WIDE BEAM

Version	Colour temperature/K	Luminous flux*/lm	System power**/W	MAGNON® article no.
SL-1000-01	□ 840/4000	5370	42	905 070 34 69

\* Lamp luminous flux  
\*\* Rounded performance ratings

## SL-1000-01 ACCESSORIES

Version	MAGNON® article no.
Eyebolts M6, galvanised steel, for pendant installation (pair)	967 901

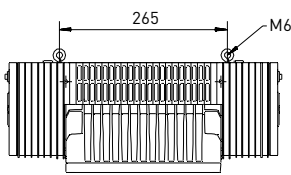

> **Eyebolts M6 (pair)**  
Galvanised steel, for pendant installation,  
Article no. 967 901 (pair)

## SL-1000-01 CONE DIAGRAM

h [m]	Ø [m]	Em [lx]
1,0	2,30 / 2,65	843
2,0	4,60 / 5,31	211
3,0	6,90 / 7,96	94
4,0	9,20 / 10,62	53
5,0	11,50 / 13,27	34
6,0	13,80 / 15,92	23

SL-1000-01, 5370 lm  
Cover screen made from single pane safety  
glass, extreme wide beam  
Article no. 905 070 34 69

## 1:1 Replacement in practical use

LED	Conventional	Energy savings*
SL-1000-01	70 W HIT-CE	53%

\* The better light guiding significantly increases the operating efficiency of the LED luminaire over a HIT-CE lamp.



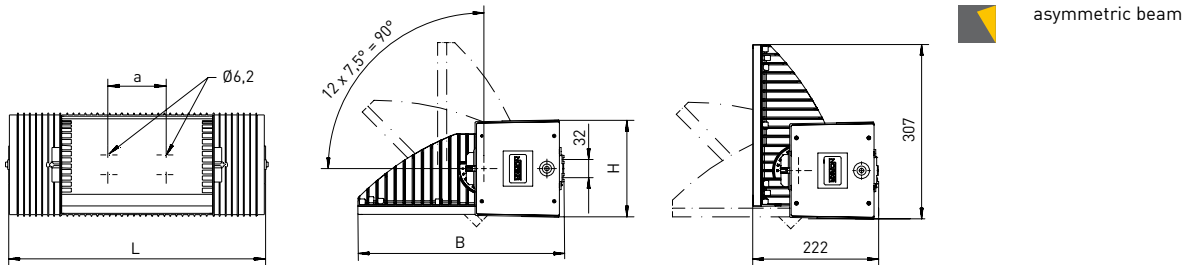

Lamp	Version	L	B	H	a	b	Max. weight
LED array	Plane floodlight	424 mm	364 mm	170 mm	96 mm	-	5.4 kg

### AREAS OF APPLICATION

Floodlight with LED array. For use in industrial facilities with different mounting heights, as well as the illumination of buildings, advertising spaces, car parks and other areas.

### HOUSING

Luminaire housing made from weather and UV resistance, fibreglass-reinforced polymer and reflector housing made from die-cast aluminium, similar to RAL 9006. Reflector housing swivelling and locking up to 90°. Thermally separated lamp chamber and transformer chamber.

Sealing system made from non-ageing, form retaining silicone/synthetic rubber. Protection rating IP 65, protection class II.

### LIGHTING TECHNOLOGY

LED arrays in a neutral white colour temperature. Cover screen made from single pane safety glass with internal aluminium reflector made from MIRO-SILVER®.

### ELECTRICAL CONSTRUCTION

Luminaire ready for mounting and installation. Built-in transformer, 220-240 V AC/DC supply voltage. Two face side cable entries M20. Two additional, concealed cable glands M20 at rear.

### MOUNTING

Ceiling or wall fixing using aluminium mounting clamp. Permanent ambient temperature -25°C to +40°C. **L80 B10 > 50,000 h.**

---

**SL-1100-01 WITH COVER SCREEN MADE FROM SINGLE PANE SAFETY GLASS, ASYMMETRIC BEAM**

<b>Version</b>	<b>Colour temperature/K</b>	<b>Luminous flux*/lm</b>	<b>System power**/W</b>	<b>MAGNON® article no.</b>
Plane floodlight	□ 840/4000	5370	42	906 070 14 69

\* Lamp luminous flux  
\*\* Rounded performance ratings



# SL-2000-01

LED

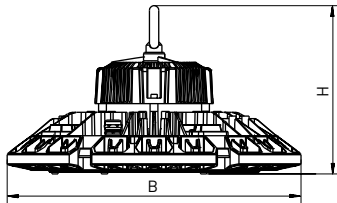

narrow beam  
with indirect  
uplighting

Lamp	Version	B	H	Max. weight
LED	Floodlight	376.9 mm	215.7 mm	6.6 kg

## AREAS OF APPLICATION

Floodlight with LED lamps. Can be used in industrial facilities with different mounting heights, such as high rack warehouses, factory and industrial halls and deep freezing facilities.

Application height 8-14 m.

## HOUSING

Die-cast aluminium housing, painted in RAL 9005, decorative ring in RAL 5024. Protection rating IP 65.

## LIGHTING TECHNOLOGY

LED lamps in a neutral white colour temperature. Cover screen made from single pane safety glass. Indirect ceiling illumination. **UGR ≤ 19.**

## ELECTRICAL CONSTRUCTION

Luminaire ready for mounting and installation. Built-in DALI transformer, 220-240 V AC/DC. Ready for connection with 3 m connecting cable.

## MOUNTING

Single mounting. Prepared for suspension system, including four eyebolts. The cable mounting must be provided on site.

Permanent ambient temperature -30°C to +35°C. **L80 B10 > 50,000 h.**

## SL-2000-01

Version	Colour temperature/K	Luminous flux*/lm	System power**/W	MAGNON® article no.
LED	□ 840/4000	22 000	150	907 080 24 61

\* Lamp luminous flux  
 \*\* Rounded performance ratings



### SL-2000-01 CONE DIAGRAM

h [m]	Ø [m]	Em [lx]
2,0	2,24	3437
4,0	4,49	859
6,0	6,73	382
8,0	8,98	215
10,0	11,22	137
12,0	13,47	95
14,0	15,71	70

SL-2000-01, 20.000 lm  
 Cover screen made from single pane safety glass, narrow beam  
 Article no. 906 080 24 61

> **Indirect uplighting for ceiling illumination**  
 High indirect uplighting, resulting in low glare

low glare  
 UGR ≤ 19

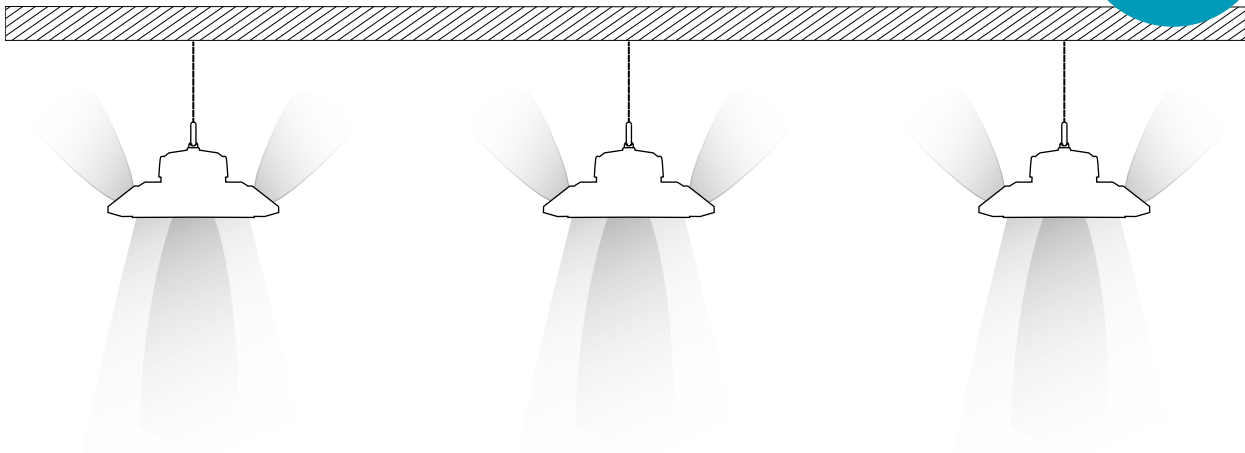







## TUBULAR LUMINAIRES

A wide range of applications can be covered in architecture by the RL-1000-01 tubular luminaire.

The luminaire is perfect for emphasising building contours or lighting rooms with low ceiling heights, for example,

underpasses or car park buildings. The high protection rating IP 69K means the luminaire can be completely cleaned with a high-pressure cleaner and hot water.

The variable mounting distances make mounting very easy.

**BEST: TO TEST!**





# TUBULAR LUMINAIRES

INDEX

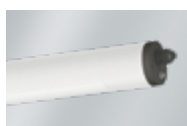



RL-1000-01 30

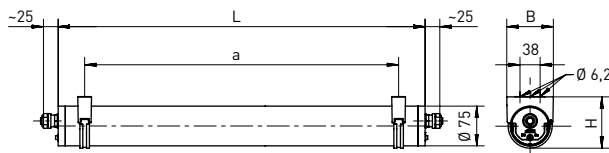
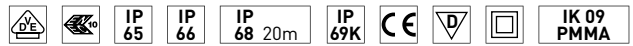

# RL-1000-01

LED



 medium beam

Lamp	Version	L	B	H	a	Max. weight
LED	m1200	1410 mm	88 mm	97 mm	1310 ± 25 mm	4.0 kg
LED	m1500	1710 mm	88 mm	97 mm	1610 ± 25 mm	4.9 kg

## AREAS OF APPLICATION

Tubular luminaire with LED lamps. For use in industrial applications, in work pits used for maintenance and repair work and for decorative indoor and outdoor lighting.

## HOUSING

Polymer luminaire tube (Ø 75 mm) with two quick-mounting pressure caps and protection against unauthorised opening. Resistant to pressurised water to 20 m according to protection rating IP 68 20 m. Unrestricted use for indoor and outdoor areas in compliance with IP 65 and IP 66. Suitable for intensive cleaning processes using pressure washers due to high protection rating IP 69K.

## LIGHTING TECHNOLOGY

Luminaire tube made of PMMA Transopal® (impact strengthened), homogeneously illuminated.

## ELECTRICAL CONSTRUCTION

Luminaire ready for mounting and installation. Built-in transformer, 230 V AC/DC. Two face-side cable glands M20 and 3 x 1.5 mm<sup>2</sup> through wiring.

## MOUNTING

Individual or row mounting. Ceiling or wall fixing using two mounting clamps made of stainless steel and black/transparent polymer with variable mounting distance, including protections against unauthorised opening. Permanent ambient temperature -25°C to +30°C. **L80 B10 > 50,000 h.**

## PL-1000-01, PMMA TRANSOPAL® (IMPACT STRENGTHENED)

Version	Colour temperature/K	Luminous flux*/lm	System power**/W	MAGNON® article no.
m1200	□ 840/4000	4660	41	325 480 34 21
m1500	□ 840/4000	5800	51	325 680 34 21

\* Lamp luminous flux  
 \*\* Rounded performance ratings

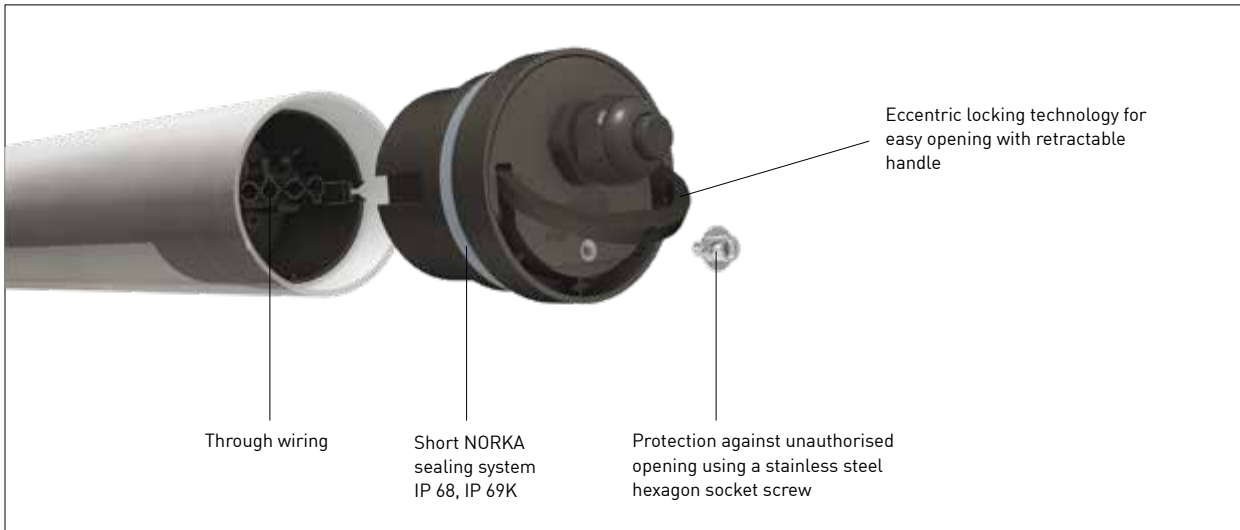

> RL-1000-01 quick-mounting pressure cap



> Mounting clamps for RL-1000-01 stainless steel and black/transparent polymer (pair), included in the scope of delivery

## RL-1000-01 CONE DIAGRAMS

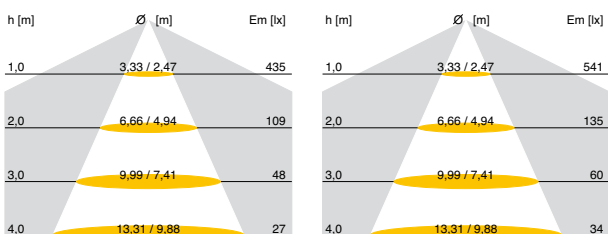

RL-1000-01, m1200, 4660 lm  
 PMMA Transopal® (impact strengthened)  
 medium beam  
 Article no. 325 480 34 21

RL-1000-01, m1500, 5800 lm PMMA  
 Transopal® (impact strengthened)  
 medium beam  
 Article no. 325 680 34 21

## VANDALISM-PROOF LUMINAIRES

Luminaires of the MAGNON® AL series are made of cast aluminium and tested at an impact energy of 20 joules. These vandalism-proof luminaires are

suitable for areas exposed to deliberate destruction, such as prisons or publicly accessible areas, such as underpasses and tunnels, stairwells and waiting

rooms, as well as weather shelters, path illumination or car park buildings.

**BEST: TO TEST!**









# VANDALISM-PROOF LUMINAIRES

INDEX

---



AL-1000-01 36

# AL-1000-01

LED



**NEW**

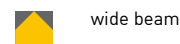
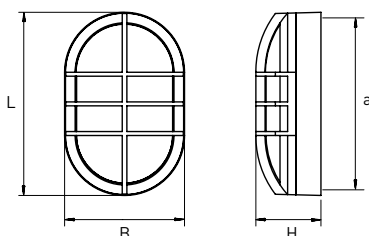

wide beam

Lamp	Version	L	B	H	a	Max. weight
LED	Without a shutter	278 mm	182 mm	98.7 mm	257.5 mm	1.6 kg
LED	With shutter	278 mm	182 mm	98.7 mm	257.5 mm	1.7 kg

## AREAS OF APPLICATION

Impact-resistant ceiling and wall surface-mounted luminaire with LED lamps.

Vandalism-proof up to 20 joules. For use in all areas at risk of deliberate or negligent destruction.

## HOUSING

Aluminium housing, colour RAL 9007, protection rating IP 65.

## LIGHTING TECHNOLOGY

LED lamps in a neutral white colour temperature. Luminaire cover made of UV-resistant PC (fracture proof), opal white.

## ELECTRICAL CONSTRUCTION

Luminaire ready for mounting and installation. Built-in transformer, 220-240 V AC/DC.

## MOUNTING

Single mounting. Ceiling or wall mounting.

Permanent ambient temperature -30°C to +35°C. **L80 B10 > 50,000 h.**

## AL-1000-01

Version	Colour temperature/K	Luminous flux*/lm	System power**/W	MAGNON® article no.
Without a shutter	□ 840/4000	1000	9	320 100 44 81
With shutter	□ 840/4000	1000	9	321 100 44 81

\* Lamp luminous flux  
 \*\* Rounded performance ratings

### AL-1000-01 CONE DIAGRAM

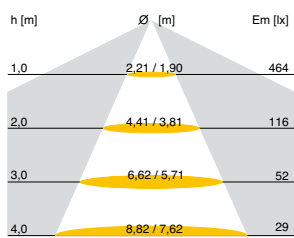

AL-1000-01, 1,000 lm  
 PC (fracture proof) opal white  
 medium beam  
 Article no. 320 100 44 81

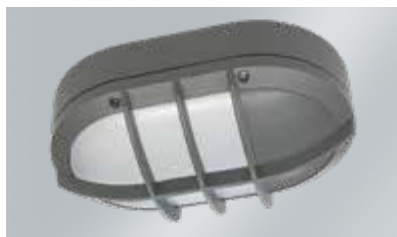

> Version AL-1100-01 with shutter  
 Article no. 321 100 44 81



# LEGAL NOTE

---

## NORKA

Norddeutsche Kunststoff- und Elektro-  
gesellschaft Stäcker mbH & Co. KG  
Lichttechnische Spezialfabrik  
Sportallee 8  
22335 Hamburg  
Germany

Postfach 63 02 63  
22312 Hamburg  
Germany

Phone: +49 40 51 30 09 0  
Fax: +49 40 51 30 09 28  
Email: info@norka.de  
Internet: www.norka.de

### **Registered office:**

Dörverden-Hülsen

### **Managing Director:**

Nicole Sass

Florian Schöpfung

### **Commercial Register:**

Walsrode Commercial Register, part A  
(HRA) 121059

**VAT no.:** DE 813 557 992

**WEEE:** DE 140 338 88

## **TECHNICAL INFORMATION:**

Despite all the care taken in producing and copying these catalogue documents, errors cannot be completely ruled out. We reserve the right to make formal and technical changes. Any measurements, weights and design details are provided without obligation. Figures may vary from the products.

Detailed technical data regarding our products can be obtained from the respective product descriptions/data sheets or requested separately.

## **PRICES:**

The prices given are recommended retail prices valid as 18/03/2018. They apply to normal commercial transactions.

Prices do not include value added tax. This will be calculated at the valid percentage rate on the day of delivery.

## **DELIVERY TERMS AND CONDITIONS:**

All deliveries shall take place in compliance with our General Conditions of Sale.

The current version of the General Sales and Warranty Terms can be found on our homepage at **www.norka.de**.

# REPRESENTATIONS/WORLDWIDE

## Australia

NORKA Lighting Sales Pty. Ltd.  
14 Knighton Avenue  
Airport West  
Melbourne, Victoria 3042  
Australia  
Tel. +61 393 315 666  
Fax +61 393 316 333  
www.norkalighting.com.au  
andrew@norkalighting.com.au

## Austria

LKD Licht Kommunal Digital  
GmbH  
Münchener Bundesstraße 144  
5020 Salzburg  
Austria  
Tel. +43 662 432 514-0  
Fax +43 662 432 514-111  
www.lkd.at  
office@lkd.at

## Belgium

Axioma nv/sa  
Mannebeekstraat 31  
8790 Waregem  
Belgium  
Tel. +32 56 622-130  
Fax +32 56 622-140  
www.axioma.be  
info@axioma.be

## Czech Republic

Elektrolicht CZ s.r.o.  
Masná 27/9  
602 00 Brno  
Czech Republic  
Tel. +42 054 532 12 84  
Fax +42 054 521 40 20  
www.elektrolicht.cz  
info@elektrolicht.cz

## Denmark

SafeExit  
Herstedøstervej 19  
2600 Glostrup  
Denmark  
Tel. +45 434 550-10  
Fax +45 434 550-11  
www.safeexit.dk  
kontakt@safeexit.dk

## Finland

Valoiste Oy  
Aleksis Kiven katu 20B  
33211 Tampere  
Finland  
Tel. +35 810 439 17 00  
Fax +35 832 220 311  
www.valoiste.fi  
info@valoiste.fi

## France

RIDI France Sàrl  
ZI du Forlen  
Impasse des Imprimeurs  
67118 Geispolsheim  
France  
Tel. +33 388 77-07 77  
Fax +33 388 77-36 99  
www.norka-luminaires.fr  
info@ridi-france.com

## Great Britain

RIDI Lighting Ltd  
8/9 The Marshgate Centre  
Parkway, Harlow Business Park  
Harlow, Essex CM19 5QP  
Great Britain  
Tel. +44 1279 45 08 82  
Fax +44 1279 45 11 69  
www.ridi.co.uk  
J.Barnard@ridi.co.uk

## Greece

Moda Light  
17th klm of Athens  
Lamia National Highway  
145-64 Kifissia Athens  
Greece  
Tel. +30 210 625 38-02  
Fax +30 210 625 38-26  
www.modalight.gr  
info@modalight.gr

## Iceland

Johan Rönnig Ltd.  
Klettagarðar 25  
104 Reykjavík  
Iceland  
Tel. +354 5 200 800  
Fax +354 5 200 888  
www.ronning.is  
ronning@ronnng.is

## Italy

Regent Illuminazione s.r.l.  
Via Vittor Pisani 16  
20124 Milan  
Italy  
Tel. +39 02 667 183 78  
Fax +39 02 673 861 09  
www.regent.ch  
info.it@regent.ch

## Luxembourg

Minusines S. A.  
8, rue Hogenberg  
1022 Luxembourg  
Luxembourg  
Tel. +35 249 58-58  
Fax +35 249 58-66 / 67  
www.minusines.lu  
info@minusines.lu

## Netherlands

Industrielight B.V.  
Van Hennaertweg 7  
2952 CA Alblasserdam  
Netherlands  
Tel. +31 786 92 09-00  
Fax +31 786 92 09-05  
www.industrielight.nl  
info@industrielight.nl

## New Zealand

iDEAL ELECTRICAL SUPPLIERS  
Level 1,  
827 Great South Road,  
Mount Wellington,  
Auckland 1061  
New Zealand  
www.rexellighting.co.nz  
www.ideal.co.nz

## Norway

Frizen Belysning  
Narviga 7  
4633 Kristiansand  
Norway  
Tel. +47 380 771-00  
Fax +47 380 771-01  
www.frizen.no  
post@frizen.no

## Poland

Krulen Spolka z o.o.  
Al. Stanów Zjednoczonych 20 A  
03-964 Warszawa  
Poland  
Tel. +48 226 166 054  
Fax +48 226 728 109  
www.krulen.com.pl  
info@krulen.com.pl

## Portugal

inolite Iluminación S.L.  
Calle Aragón 390 - 394, 3º  
08013 Barcelona  
Spain  
Tel. +34 935 405 066  
Fax +34 935 405 066  
info@inolite.com  
www.inolite.com

## Romania

ODRA IMPEX,95 SRL  
Saint Agnes Street no. 206  
Popesti – Leordeni  
77160 Ilfov County  
Romania  
Tel./Fax +40 213 69 85-22  
Tel./Fax +40 213 69 85-21  
www.odra.ro  
odra@odra.ro

## Russia

LIH Light Impex Henze GmbH  
Bürgermeister-Schwaiger-  
Straße 43  
85567 Grafing bei München  
Germany  
Tel. +49 809 270 995-7  
Fax +49 809 270 995-8  
www.lih.de  
info@lih.de

## Slovenia

ES d.o.o.  
Ob Zeleni jami 9  
1000 Ljubljana  
Slovenia  
Tel. +38 615 40 16-50  
Fax +38 615 40 16-49  
www.es-svetila.com  
prodaja@es-svetila.com

## Spain

inolite Iluminación S.L.  
Calle Aragón 390 - 394, 3º  
08013 Barcelona  
Spain  
Tel. +34 935 405 066  
Fax +34 935 405 066  
info@inolite.com  
www.inolite.com

## Sweden

Fergin Sverige AB  
Bangardsgatan 9  
591 35 Motala  
Sweden  
Tel. +46 141 500 25  
Fax +46 141 536 94  
www.fergin.se  
info@fergin.se

## Switzerland

Regent Beleuchtungskörper AG  
Dornacherstraße 390  
4018 Basel  
Switzerland  
Tel. +41 61 335 51 11  
Fax +41 61 335 52 04  
www.regent.ch  
info.bs@regent.ch

